



COMPACT FINDER



4G



Thank you for purchasing our FINDER!

Before starting:

Read the instructions carefully, before using the FINDER for the first time. Please keep this user manual in a safe place in case you may need it in the future.

1.1 Scope of delivery	3
1.2 Product description	4
1.3 Instructions for charging	5
1.4 Activation	7
1.5 Start-up	8
1.6 Handling of the SOS button.....	9
1.7 Use.....	10
1.8 Standby mode and location update.....	11
1.9 Short description FINDER-Portal	12
1.10 Meaning of the LED lights.....	14
1.11 Alerts	16
1.12 Technical data	17
1.13 Safety Instructions.....	18
1.14 Disposal of used batteries	24
1.15 Disposal of electric devices	25

NOTE!

We update our user manuals on a regular basis, in order to keep them up to date. The latest version can be viewed at any time at: paj-gps.com/finder

1.1 Scope of delivery

Your delivery will include:

- The PAJ COMPACT Finder 4G
- A charging cable
- A quick start flyer
- A M2M SIM card*



*the M2M SIM card is already inside your FINDER and is not replaceable.

1.2 Product description



NOTE!

To activate, you need the device ID. Please have it ready or write it down.

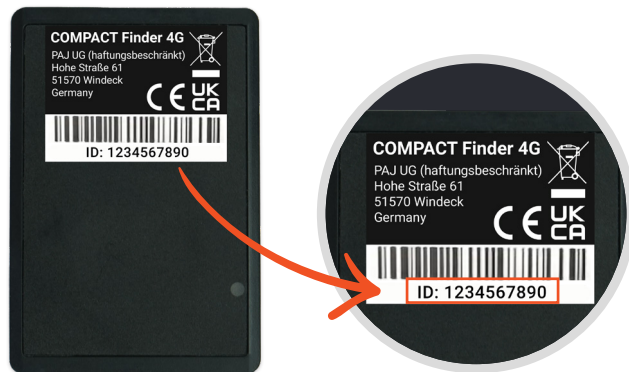

1.3 Instructions for charging

You should fully charge the FINDER before using it for the first time. Please proceed as follows.

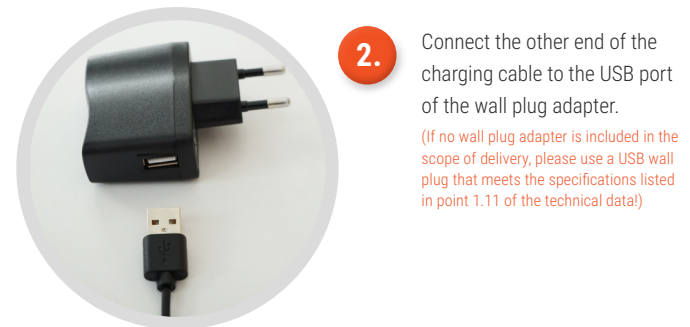
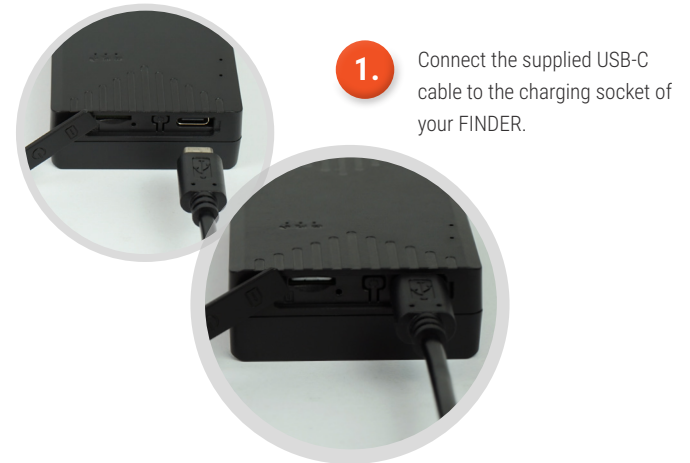

3.

Plug the USB wall plug adapter into a power socket.



4.

Wait for the end of the charging process. The unit is fully charged when the red LED goes out, see „1.9 Meaning of the LED lights“ of this manual.

NOTE!

In rare cases, the LEDs do not indicate that the FINDER is fully charged when charging for the first time. If the LED lights still do not indicate the end of charging after 10 hours of charging, please disconnect the FINDER from the power supply and start using it. Then simply check the battery level in the FINDER-Portal.

With an active tracking time of approx. 1 hour per day, the COMPACT Finder 4G offers a battery life of approx. 20 days without charging in between! However, it should be noted that the runtime depends on the utilisation. The more the device is moved and the more alarms are sent, the higher the utilisation.

1.4 Activation

In order to use your COMPACT Finder 4G, you will need to previously activate it online. Enter the following link and follow the instructions:

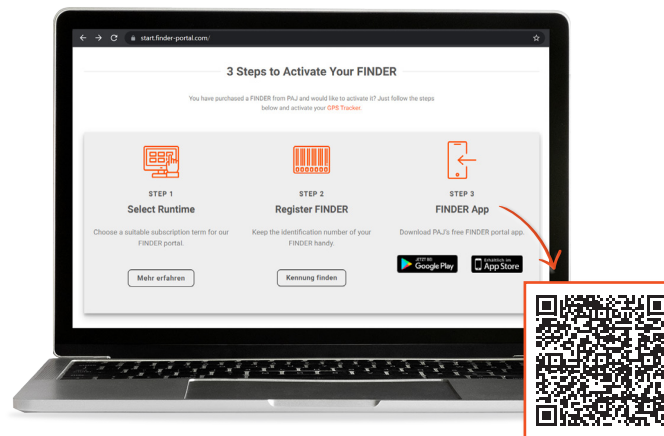
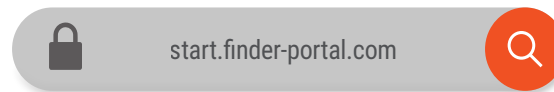

1.5 Start-up

If the activation is successfully carried out, the FINDER is ready to be switched on. The on/off button is located under the protective flap.

Switch on:

Press the button briefly **once** to turn the device on. The LEDs then flash until the GPS tracker has GPS or network reception. For information regarding the LED lights, see section „1.9 Meaning of the LED lights“.

Switch off:

Press the button **5 times** within **5 seconds**. The FINDER then switches off.

This device has a switch-off alarm. The device switches off with a delay of **40 seconds** so that this alarm can be triggered and transmitted before it is switched off.



NOTE!

We recommend that after you start your device for the first time you move it in an open space (for example during a walk or a short car ride). This can speed up the connection process, meaning that your device will connect to the best available network more quickly. A good network connection is required in order for the device to send and log data in the FINDER Portal.

1.6 Use



As soon as your device has been successfully activated, started up and has sent and logged data for the first time, you can place it wherever you choose and use your phone, tablet or PC to start tracking it! You will be able to do this in our App or enter the following link to the desktop version:

v2.finder-portal.com



1.7 Short description FINDER-Portal

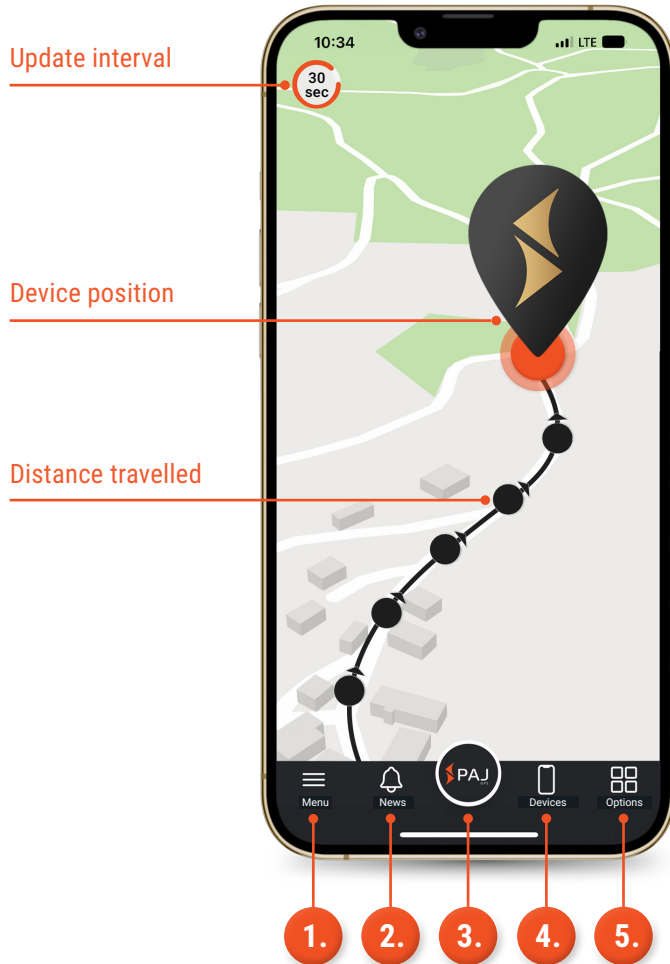

1. Application menu

View statistics, device settings, application settings, alert summary, extra features e.g. logbook etc.

2. Alerts and activities

Last activity, unread notifications, timeline

3. PAJ Logo

Update page/refresh

4. Device list

Overview devices, alert settings, travelled routes, customize device display

5. Options

Map view options



Detailed instructions for the FINDER-Portal can be found on: paj-gps.de/portal-anleitung

or scan this QR-Code.

1.8 Standby mode and location update

The PAJ COMPACT Finder 4G sends its location information by default every 30 seconds to the FINDER portal when in motion. The transmission interval can be individually adjusted via the FINDER portal. Once the GPS tracker is stationary, the device switches to standby mode to save energy. The transmission of location data seamlessly continues once the device is in motion again.

What is the standby mode?

As soon as the FINDER is no longer moved, standby mode is activated after a few minutes to save power. This suspends the update of the location for the duration of the standstill of the unit. In the FINDER portal, the standby mode is displayed as follows:

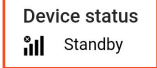

Nevertheless, the unit naturally remains on standby and still sends alarm messages. As long as the FINDER is in standby mode, only the data (time, battery status, etc.) of the last position before standby mode is displayed on the portal, as the position does not change during standby.

Online mode

At the latest, when the FINDER is moved again, the device automatically switches to active and sends its position to the portal again every 30 seconds.

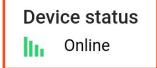

Location update in standby mode

If the FINDER is in standby mode for a longer period of time, the unit will still send a new position to the portal at least every 24 - 26 hours.

1.9 Meaning of the LED lights

Orange LED - Network



Signal	Meaning
The orange LED is on	Signal available
The orange LED flashes	No signal available
The orange LED is off	The GPS tracker is in standby mode* or switched off

Red LED - Battery status



Signal	Meaning
The red LED is on	Battery is charging (charging cable connected)
The red LED is off	Battery fully charged (charging cable connected)

Blue LED - GPS status



Signal	Meaning
The blue LED is on	GPS signal available
The blue LED flashes	No GPS signal available
The blue LED is off	The GPS tracker is in standby mode* or switched off

1.10 Alerts



Movement/Shock alert

Receive a notification as soon as your GPS tracker is either moved or shaken.



Geofence alert

Receive a notification as soon as your GPS tracker leaves your determined perimeter.



Speed alert

Receive a notification as soon as your GPS tracker exceeds a certain speed (you can set the speed limit in the FINDER Portal).



Battery alert

Receive a notification when your tracker's battery level is low.



Drop alert

Receive a notification as soon as the FINDER is lifted.



Power-off alert

Receive a notification as soon as the GPS tracker is switched off.

NOTE!

All alerts must be activated and deactivated via the FINDER-Portal. Once the alert is active you will receive a notification via the PAJ App and/or via email.

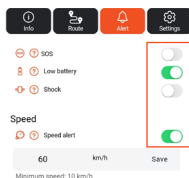

1.11 Technical data

Weight	124 g
Dimensions	78 x 54 x 21 mm
Battery time	in operation* : approx. 20 days / in continuous operation : approx. 7 days
Battery type	3.7 V / 5000 mAh Li-ion
Charger	110-220 V, AC 50 Hz input 5 V/1A, DC output
Time to start	cold start : 3-5 min / standby : 1-3 min / in operation : 1-10 s
Network/Bands	LTE (23 dBm ± 2.7 dBm) : B1/B3/B5/B7/B8/B20 GSM/GPRS : GSM 900 (33 dBm ± 2 dBm) DCS 1800 (30 dBm ± 2 dBm)
Network module	SIMCOM A7670E
GPS chip	AT6558R
GPS accuracy	up to 5 meters
GPS reception	cold start : -148 dBm in operation : -156 dBm tracking : -162 dBm
Storage temperature	from -30 °C up to +80 °C
Operating environment	from -20 °C up to +75 °C
Humidity	10 % up to 85 %
Water protection	waterproof according to IP65

*in motion about one hour a day.

1.13 Safety Instructions

Signal words

The following signal words are used in these operating instructions:

NOTE!

This is a warning about possible damage to property.

WARNING!

This classifies a hazard of medium risk level. Failure to comply with the warning may result in serious injury.

Proper use

Please read the safety instructions for this PAJ FINDER, hereinafter only referred to as GPS tracker, carefully before use in order to be able to deploy it properly. The intended use is to employ the GPS tracker only as described in this manual to locate an object or a living being. Please bear in mind that it is a criminal offence to monitor third parties using a GPS tracker without their consent. If you use it in any other way, this is considered improper use and can lead to damage to property or even personal injury. Please note that the GPS tracker is not a toy for children. In other countries and regions there are different laws on digital positioning and localization of people, animals and/or objects. PAJ UG is not responsible if such laws or regulations are violated, this is the sole responsibility of the user.

NOTE!

The manufacturer and dealer accept no liability for damage caused by improper or incorrect use.

Safety



WARNING! RISK OF ELECTRIC SHOCK!

A faulty electrical installation or a mains voltage that is too high can lead to an electric shock.

- Before use, make sure that the mains voltage of the socket corresponds with the information on the type plate.
- To be able to disconnect the charging cable from the mains as quickly as possible in the event of a failure, connect the power supply unit where it is easily accessible.
- If you notice any visible damage to your GPS tracker or charging cable, do not use it.
- Use only the original parts supplied to charge the GPS tracker. If the charging cable is damaged, replace it only with original accessories from the manufacturer.
- Never place the GPS tracker near an open fire or hot surfaces.
- The charging cable should only be used indoors. Keep it away from humidity and do not kink it.
- Do not open the housing of the GPS tracker. Leave the repair to qualified specialists. However, if you carry out repairs yourself, connect the GPS tracker incorrectly or operate it incorrectly, liability and warranty claims are excluded.

Hazards for children and vulnerable people



WARNING! DANGER OF SUFFOCATION!

Please do not let people (including children) with limited physical, sensory or mental abilities use the GPS tracker. It is considered an exception if they have previously received instructions from a person responsible for their safety on how to use the device.

Please make sure that your child does not handle small parts (e.g. accessories, etc.). These can be swallowed and lead to suffocation.

NOTE!

Inform your child about the dangers and use of the GPS tracker.

The battery



WARNING! EXPLOSION AND FIRE HAZARD!

Below you will find information and instructions on how to use the battery:

- The GPS tracker runs by a lithium ions battery. It is not exchangeable and must not be removed or opened.
- Make sure that the GPS tracker (also when charging the battery) is kept away from heat sources and high temperatures, such as direct sunlight in a vehicle. **Disregard of this instruction may result in destruction of the battery and overheating, explosion and fire.**
- Only use the original accessories for the charging process. If the battery is charged otherwise, this may result in overheating, explosion or fire.
- Do not burn or pierce the GPS tracker. Protect it from mechanical damage.
- If a child swallows the battery, seek medical aid immediately!

Removing or replacing the battery:

- Contact our support if the battery needs to be removed or replaced.
- Send the machine to us to remove or replace the battery.

- For safety reasons, do not attempt to remove the battery. Failure to remove the battery properly may result in damage to the battery and unit, personal injury and/or compromise the safety of the unit.
- PAJ GPS shall not be liable for any damage or loss (whether in contract or tort, including negligence) arising from your failure to comply with these warnings and instructions.



WARNING! RISK OF CHEMICAL BURNS!

Batteries that leak due to damage can cause burns if they come into contact with the skin. Therefore, never open the battery. However, if the battery leaks, please wear protective gloves.

Electromagnetic compatibility

Please observe all rules and prohibitions and switch off the GPS tracker immediately in danger areas and if it might cause interference. Furthermore, it should not be used in the vicinity of, for example, medical equipment, fuels and chemicals, or in blasting areas. With mobile devices, malfunction due to interference may occur and affect performance. Transformers and very strong magnetic fields must be avoided. Otherwise there may be deviations in the transmission.

NOTE!

Failure to observe these recommendations may result in malfunctions or damage to the GPS tracker.

Cleaning



WARNING! RISK OF DAMAGE!

Below you will find information and instructions on how to clean the GPS tracker:

- Do not use aggressive cleaning agents or brushes for cleaning. **Do not clean the GPS tracker with metallic cleaning objects (e.g. knife, metal sponge). This may damage the surface.**
- Never put the GPS tracker in water, in a dishwasher (or the like) and do not use a steam cleaner.

Correct cleaning:

- The surface may be wiped clean with a slightly dampened cloth.
- The GPS tracker should then be wiped dry completely.

Storage

If you are not using the GPS tracker for a lengthy period of time, turn it off. Place the tracker in its original packaging or in a carton of the same size. Protect the tracker from dirt and humidity.

NOTE!

Keep the FINDER away of children's reach in order to avoid possible damage to property or personal injury.

Declaration of conformity

Hereby, PAJ UG (haftungsbeschränkt) declares that the tracker, COMPACT Finder 4G, is in conformity with the Directive 2014/53/EU. The complete text of the EU Declaration of Conformity can be found at the following Internet address:

paj-gps.de/konformitaetserklaerung/



Packaging disposal

Dispose of the packaging according to type. Throw cardboard and paper to the corresponding container. Foil belongs in the recyclables collection.



1.14 Disposal of used batteries

The following note is addressed to those who use batteries or products with products with built-in batteries and who will not resell them in the form in which they were supplied to them (end users).

Free recall of used batteries

Batteries must not be disposed of with waste. You are legally obliged to return used batteries so that proper disposal can be guaranteed. You can return used batteries to a local collection point or to your local retailer. As a distributor of batteries, we are also to take back used batteries, although our obligation to take back used is limited to the type which we carry or have carried as batteries in our range. Used batteries of the aforementioned type can therefore either be returned to us with sufficient postage or handed in directly to our dispatch warehouse at the following address free of charge:

PAJ UG (haftungsbeschränkt)

Hohe Straße 61

51570 Windeck

Germany

E-Mail: info@paj-gps.de

Meaning of the battery symbols

Batteries are marked with the symbol of a crossed-out dustbin (see illustration). This symbol indicates that batteries must not be disposed of in household waste. Batteries containing more than 0.0005% mercury by mass, more than 0.002% cadmium by mass or more than 0.004% lead by mass are also marked with the chemical name of the pollutant below the dustbin symbol. The abbreviation „Cd“ stands for cadmium, „Pb“ for lead and „Hg“ for mercury.



1.15 Disposal of electric devices

The Electrical and Electronic Equipment Act (ElektroG) contains a large number of requirements for the handling of electrical and electronic equipment. The most important ones are summarised here:

1. Separate collection of WEEE

Waste Electrical and Electronic Equipment that has become waste is referred to as WEEE. Owners of WEEE must dispose of it separately from unsorted local waste. In particular, WEEE does not belong in household waste, but in special collection and return systems.

2. Batteries and accumulators

As a rule, owners of WEEE must separate spent batteries and accumulators that are not enclosed in the WEEE before handing them over at a collection point. This does not apply if the WEEE is handed over to public waste management authorities and separated from other WEEE there for the purpose of preparation for reuse.

3. Options for returning old appliances (WEEE)

Owners of WEEE from private households can hand it in to public waste management authorities or at the collection points set up by manufacturers or distributors as defined by the ElektroG. An online directory of collection and collection points can be found here:

<https://www.ear-system.de/ear-verzeichnis/sammel-und-ruecknahmestellen.jsf>

4. Data protection

Old equipment often contains sensitive personal data. This applies in particular to information and telecommunication technology devices such as computers and smartphones. For your own sake, please note that each end-user is responsible for deleting the data on the old equipment to be disposed of.

5. Meaning of the „crossed-out dustbin“ symbol

The symbol of a crossed-out dustbin regularly displayed on electrical and electronic equipment indicates that the respective device must be separated from unsorted local waste at the end of its service life.



6. Manufacturer registration number

As a manufacturer, within the meaning of the ElektroG, we are registered with the responsible foundation Elektro-Altgeräte Register (Benno-Strauß-Str. 1, 90763 Fürth) under the following registration number: **DE33887550**

DO YOU HAVE ANY QUESTIONS?



In this case, please contact us
and we will be delighted to help you!

PAJ UG (haftungsbeschränkt)
Hohe Straße 61
51570 Windeck
Germany

Mail: support@paj-gps.com
Phone: +49 2292 39 499 59
Web: paj-gps.com

The PAJ GPS Team wishes you to enjoy your
COMPACT Finder 4G!



PAJ UG (haftungsbeschränkt)
Hohe Straße 61, 51570 Windeck
Germany